

Presidential Mezzanine

Convention Center | Level M

NOTES:

Grid of dotted lines for notes.

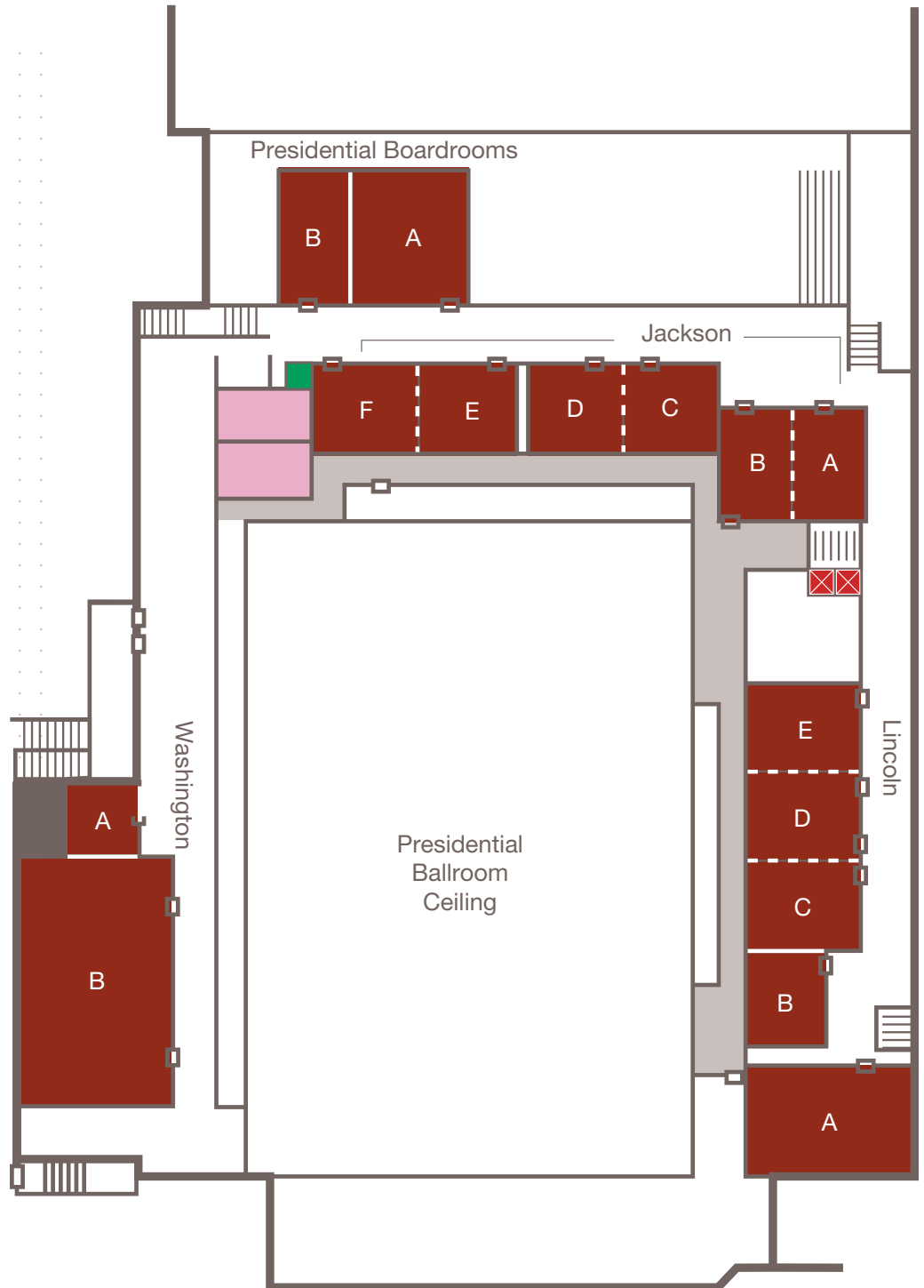

KEY	
■	Freight Elevators
■	Guest Elevators
■	Service Areas
■	Restrooms

NOTES:

- Level M (Mezzanine) offers meeting and breakout rooms that accommodate multiple sized groups
- Mezzanine meeting and breakout rooms are conveniently located one level above the ballrooms
- On-site audio/visual company offers a wide range of state-of-the-art services including audio/visual equipment, lighting, staging, special effects and logistical support

	SQUARE FEET	THEATER	CLASSROOM	CONFERENCE / HOLLOW SQUARE	U-SHAPE	ROUNDS OF 10	RECEPTION	LENGTH	WIDTH	HEIGHT
Presidential Mezzanine										
Lincoln A	1,548	150	74	38	44	110	141	46' 8"	33' 2"	10' 4"
Lincoln B	588	45	24	26	29	40	53	29' 9"	19' 9"	10' 5"
Lincoln C	965	96	60	28	32	60	88	33' 8"	28' 8"	10' 4"
Lincoln D	962	96	60	28	32	60	88	33' 8"	28' 7"	10' 4"
Lincoln E	965	96	60	28	32	60	88	33' 8"	28' 8"	10' 4"
Jackson A	808	80	45	30	35	60	73	36' 4"	22' 3"	10' 5"
Jackson B	833	80	45	30	35	60	76	36' 4"	22' 11"	10' 5"
Jackson C	854	70	48	26	32	50	78	30' 7"	27' 11"	10' 5"
Jackson D	784	70	48	26	21	40	71	28' 1"	27' 11"	10' 5"
Jackson E	886	80	48	36	42	50	81	27' 11"	31' 9"	10' 4"
Jackson F	889	80	42	36	42	50	81	27' 11"	31' 10"	10' 5"
Presidential Boardroom A	1,365	144	60	30	30	90	124	39' 11"	37'	9' 11"
Presidential Boardroom B	679	60	36	25	35	40	62	38' 5"	17' 8"	10'
Washington A	298	24	12	12	14	10	27	19' 9"	15' 1"	8' 11"
Washington B	3,707	306	195	50	40	240	337	82' 10"	44' 9"	11'

Capacities shown in this book are maximum for each room, with no staging or audio-visual, and should be used for reference only. Room capacities will be diminished based on your staging and audio-visual needs.