

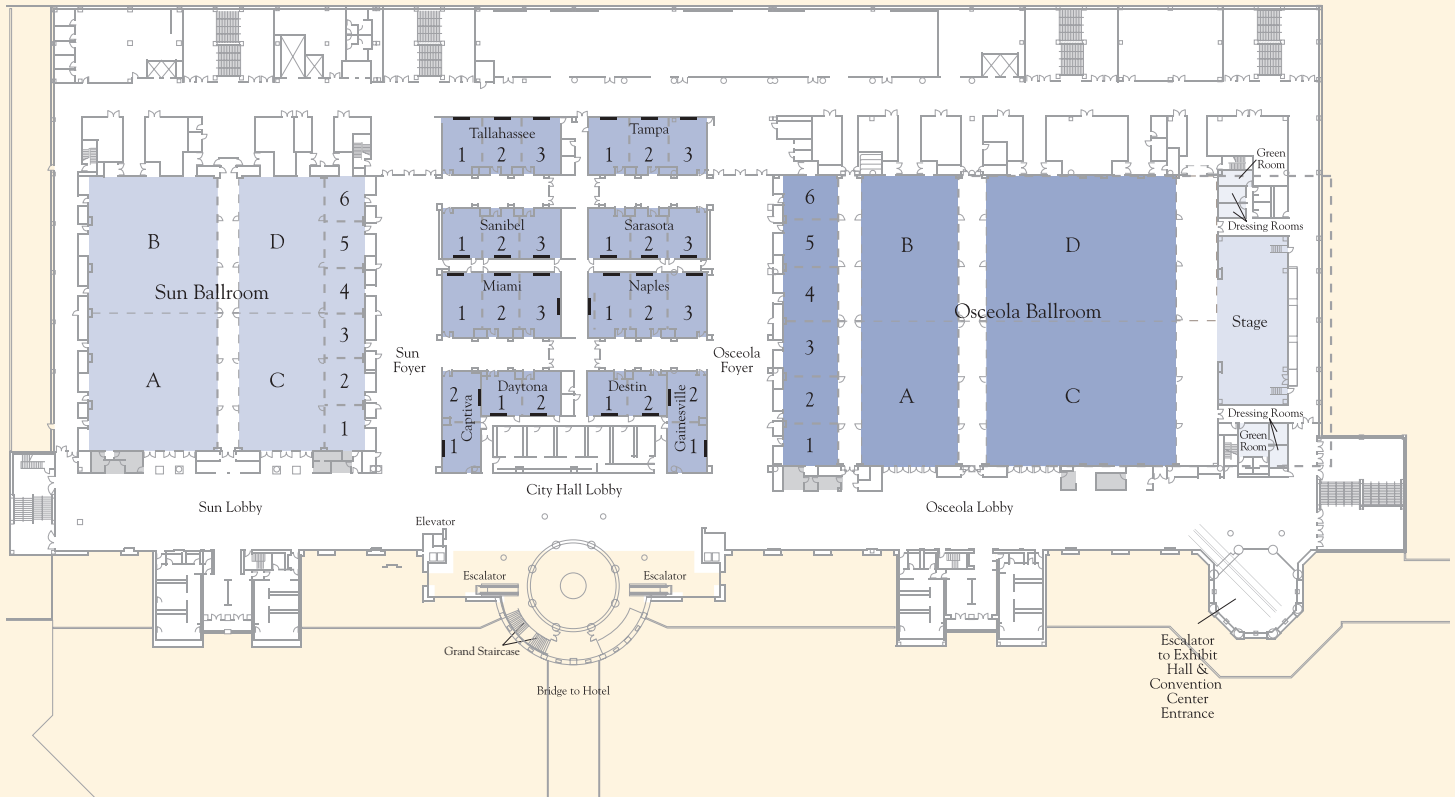

# GAYLORD PALMS BALLROOM LEVEL



MEETING ROOM	TOTAL SQ. FT.	THEATER	BANQUET	CLASSROOM	CONF/HOLLOW SQ.	U CONFERENCE	RECEPTION	WIDTH	LENGTH	CEILING HT.
<b>BALLROOM LEVEL</b>										
<b>SUN</b>	<b>29,014</b>	<b>3,040</b>	<b>1,960</b>	<b>1,860</b>			<b>2,520</b>	<b>179'</b>	<b>187'</b>	<b>24'</b>
A	6,682	665	490	450			580	84'	89'	24'
B	6,863	665	490	450			595	84'	98'	24'
C	4,350	418	280	285			375	52'	89'	24'
D	4,556	418	280	285			395	52'	98'	24'
AB/CD CORRIDOR	2,127							13'	187'	24'
<b>BREAKOUT 1</b>	<b>767</b>	<b>70</b>	<b>40</b>	<b>34</b>	<b>34</b>	<b>28</b>	<b>65</b>	<b>30'</b>	<b>33'</b>	<b>24'</b>
<b>BREAKOUT 2</b>	<b>762</b>	<b>72</b>	<b>40</b>	<b>45</b>	<b>34</b>	<b>26</b>	<b>65</b>	<b>30'</b>	<b>29'</b>	<b>24'</b>
<b>BREAKOUT 3</b>	<b>663</b>	<b>71</b>	<b>40</b>	<b>45</b>	<b>34</b>	<b>26</b>	<b>55</b>	<b>27'</b>	<b>27'</b>	<b>24'</b>
<b>BREAKOUT 4</b>	<b>667</b>	<b>71</b>	<b>40</b>	<b>45</b>	<b>34</b>	<b>26</b>	<b>60</b>	<b>27'</b>	<b>27'</b>	<b>24'</b>
<b>BREAKOUT 5</b>	<b>768</b>	<b>73</b>	<b>40</b>	<b>45</b>	<b>34</b>	<b>26</b>	<b>65</b>	<b>30'</b>	<b>29'</b>	<b>24'</b>
<b>BREAKOUT 6</b>	<b>809</b>	<b>69</b>	<b>40</b>	<b>34</b>	<b>34</b>	<b>28</b>	<b>70</b>	<b>30'</b>	<b>42'</b>	<b>24'</b>

Capacities shown are maximum for each room, with no staging or audio-visual, and should be used for reference only. Room capacities will be diminished based on your staging and audio-visual needs.



# GAYLORD PALMS BALLROOM LEVEL CONT.

MEETING ROOM	TOTAL SQ. FT.	THEATER	BANQUET	CLASSROOM	CONF/HOLLOW SQ.	U CONFERENCE	RECEPTION	WIDTH	LENGTH	CEILING HT.
<b>CITY HALL AREA</b>										
<b>CAPTIVA</b>	<b>1,364</b>	<b>138</b>	<b>90</b>	<b>88</b>	<b>54</b>	<b>48</b>	<b>120</b>	<b>23'</b>	<b>61'</b>	<b>12'</b>
1	676	72	40	40	30	21	60	23'	30'	12'
2	688	72	40	40	30	21	60	23'	31'	12'
<b>DAYTONA</b>	<b>1,193</b>	<b>118</b>	<b>70</b>	<b>85</b>	<b>48</b>	<b>40</b>	<b>105</b>	<b>48'</b>	<b>27'</b>	<b>12'</b>
1	592	59	40	30	28	20	50	24'	27'	12'
2	602	66	30	36	28	20	50	24'	27'	12'
<b>DESTIN</b>	<b>1,186</b>	<b>118</b>	<b>70</b>	<b>85</b>	<b>48</b>	<b>40</b>	<b>105</b>	<b>48'</b>	<b>27'</b>	<b>12'</b>
1	597	66	30	36	28	20	50	24'	27'	12'
2	589	62	40	30	28	20	50	24'	27'	12'
<b>GAINESVILLE</b>	<b>1,361</b>	<b>138</b>	<b>90</b>	<b>88</b>	<b>54</b>	<b>48</b>	<b>120</b>	<b>23'</b>	<b>61'</b>	<b>12'</b>
1	674	72	40	40	30	21	60	23'	30'	12'
2	687	72	40	40	30	21	60	23'	31'	12'
<b>MIAMI</b>	<b>2,626</b>	<b>272</b>	<b>210</b>	<b>193</b>	<b>84</b>	<b>73</b>	<b>230</b>	<b>72'</b>	<b>39'</b>	<b>12'</b>
1	881	104	60	60	38	29	75	24'	39'	12'
2	858	101	60	60	38	29	75	24'	39'	12'
3	887	105	60	66	38	29	75	24'	39'	12'
<b>NAPLES</b>	<b>2,602</b>	<b>272</b>	<b>210</b>	<b>193</b>	<b>84</b>	<b>73</b>	<b>225</b>	<b>71'</b>	<b>39'</b>	<b>12'</b>
1	882	105	60	66	38	29	75	23'	39'	12'
2	848	101	60	60	38	29	75	24'	39'	12'
3	872	104	60	60	38	29	75	24'	39'	12'
<b>SANIBEL</b>	<b>2,023</b>	<b>238</b>	<b>120</b>	<b>132</b>	<b>76</b>	<b>66</b>	<b>175</b>	<b>72'</b>	<b>30'</b>	<b>12'</b>
1	700	84	40	44	32	24	60	24'	30'	12'
2	642	65	40	40	30	22	55	24'	30'	12'
3	681	79	40	46	30	24	60	24'	30'	12'
<b>SARASOTA</b>	<b>2,018</b>	<b>238</b>	<b>120</b>	<b>132</b>	<b>76</b>	<b>66</b>	<b>175</b>	<b>71'</b>	<b>30'</b>	<b>12'</b>
1	674	79	40	46	30	22	60	23'	30'	12'
2	644	65	40	40	30	22	22	24'	30'	12'
3	700	84	40	44	32	24	60	24'	30'	12'
<b>TALLAHASSEE</b>	<b>2,273</b>	<b>249</b>	<b>150</b>	<b>170</b>	<b>78</b>	<b>69</b>	<b>200</b>	<b>72'</b>	<b>34'</b>	<b>12'</b>
1	777	84	50	50	34	24	70	25'	34'	12'
2	699	78	50	45	34	24	60	23'	34'	12'
3	797	98	50	56	34	24	70	24'	34'	12'
<b>TAMPA</b>	<b>2,269</b>	<b>249</b>	<b>150</b>	<b>170</b>	<b>78</b>	<b>69</b>	<b>200</b>	<b>70'</b>	<b>34'</b>	<b>12'</b>
1	794	84	50	48	34	24	70	24'	34'	12'
2	694	78	50	45	34	24	60	22'	34'	12'
3	781	84	50	50	34	24	70	24'	34'	12'
<b>BALLROOM LEVEL CONT.</b>										
<b>OSCEOLA</b>	<b>46,748</b>	<b>5,561</b>	<b>3,450</b>	<b>3,366</b>			<b>4,200</b>	<b>265'</b>	<b>190'</b>	<b>24'</b>
A	5,208	560	400	322			450	59'	94'	24'
B	5,326	560	400	322			460	59'	96'	24'
C	10,270	1,092	700	660			890	115'	94'	24'
D	10,385	1,092	700	660			900	115'	96'	24'
AB/CD CORRIDOR	2,792							14'	190'	24'
CD/STAGE CORRIDOR	4,328							23'	190'	24'
1-6/AB CORRIDOR	2,186							12'	190'	24'
<b>BREAKOUT 1</b>	<b>949</b>	<b>89</b>	<b>60</b>	<b>49</b>	<b>40</b>	<b>29</b>	<b>80</b>	<b>39'</b>	<b>32'</b>	<b>24'</b>
<b>BREAKOUT 2</b>	<b>1,005</b>	<b>105</b>	<b>70</b>	<b>63</b>	<b>40</b>	<b>29</b>	<b>90</b>	<b>39'</b>	<b>29'</b>	<b>24'</b>
<b>BREAKOUT 3</b>	<b>1,171</b>	<b>112</b>	<b>90</b>	<b>74</b>	<b>46</b>	<b>32</b>	<b>100</b>	<b>39'</b>	<b>33'</b>	<b>24'</b>
<b>BREAKOUT 4</b>	<b>1,132</b>	<b>112</b>	<b>90</b>	<b>74</b>	<b>46</b>	<b>32</b>	<b>100</b>	<b>39'</b>	<b>32'</b>	<b>24'</b>
<b>BREAKOUT 5</b>	<b>1,008</b>	<b>105</b>	<b>80</b>	<b>69</b>	<b>40</b>	<b>30</b>	<b>85</b>	<b>39'</b>	<b>29'</b>	<b>24'</b>
<b>BREAKOUT 6</b>	<b>988</b>	<b>93</b>	<b>60</b>	<b>50</b>	<b>40</b>	<b>30</b>	<b>85</b>	<b>39'</b>	<b>35'</b>	<b>24'</b>
<b>STAGE</b>										
<b>STAGE 42' X 96'</b>										
STAGE LEFT		GREEN ROOM 1—200 SQ. FT.		DRESSING ROOM 1—150 SQ. FT.			DRESSING ROOM 3—180 SQ. FT.			
STAGE RIGHT		GREEN ROOM 2—250 SQ. FT.		DRESSING ROOM 2—150 SQ. FT.						
<b>7 OFFICES (LOCKABLE)</b>		<b>RANGE 65–163 SQ. FT.</b>								
<b>6 REGISTRATION DESKS (LOCKABLE)</b>		<b>APPROX. 80 SQ. FT.</b>								

Capacities shown are maximum for each room, with no staging or audio-visual, and should be used for reference only. Room capacities will be diminished based on your staging and audio-visual needs.



# GAYLORD PALMS EXHIBITION HALL

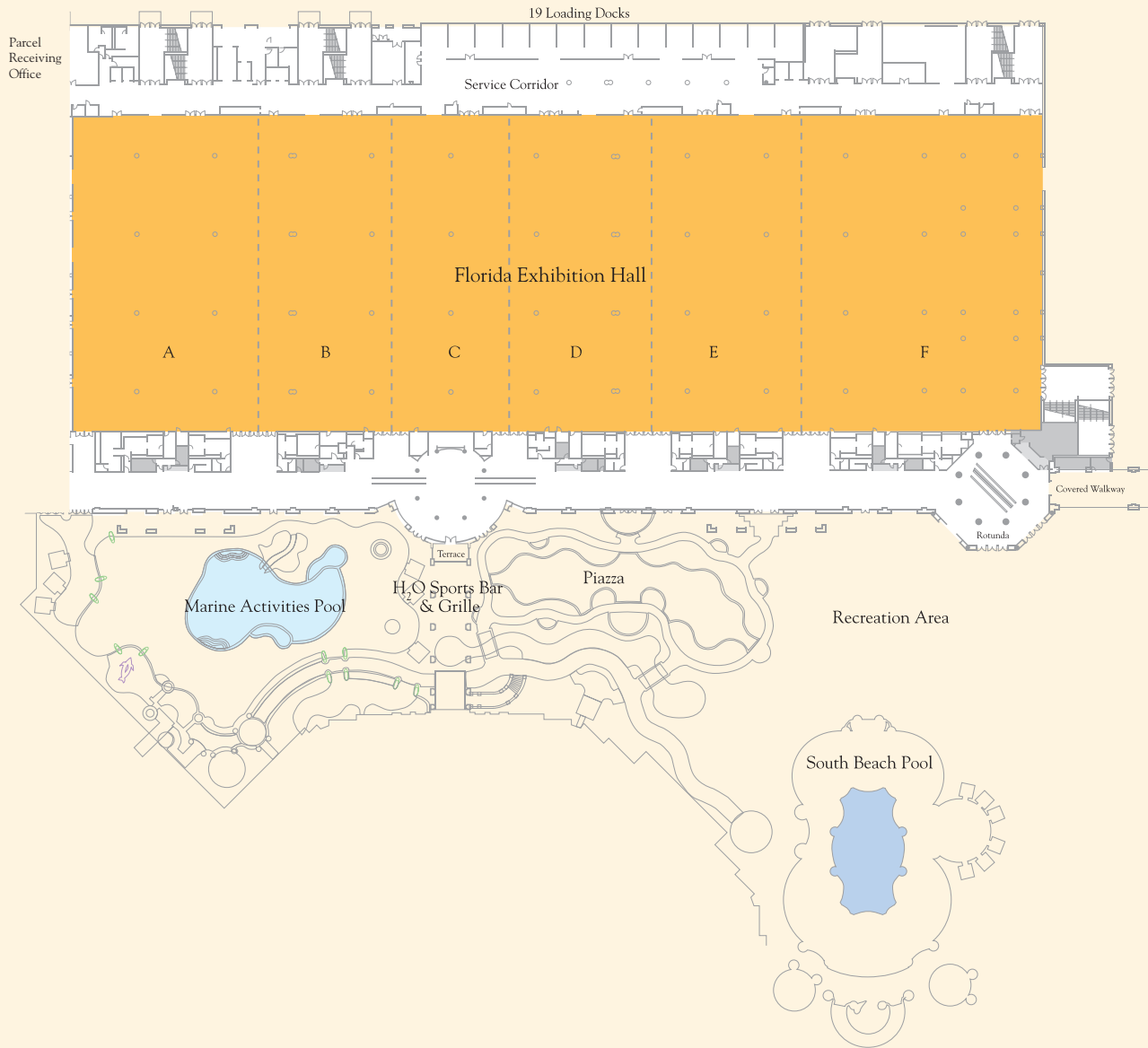

ROOM	TOTAL SQ. FT.	8 x 10 BOOTHS	10 x 10 BOOTHS	THEATER	BANQUET	RECEPTION	CLASSROOM	MODULAR BREAKOUTS	WIDTH	LENGTH	CEILING HT.
<b>FLORIDA EXHIBITION HALL</b>											
<b>TOTAL</b>	<b>178,500</b>	<b>1,116</b>	<b>893</b>	<b>21,326</b>	<b>11,928</b>	<b>14,770</b>	<b>12,792</b>	<b>173</b>	<b>740'</b>	<b>241'</b>	<b>24'</b>
SECTION A	34,300	214	172	4,276	2,328	2,860	2,568	34	142'	241'	24'
SECTION B	24,570	154	123	2,725	1,620	2,020	1,653	23	102'	241'	24'
SECTION C	21,700	136	109	2,746	1,400	1,850	1,419	22	90'	241'	24'
SECTION D	24,570	154	123	2,725	1,620	2,020	1,653	23	102'	241'	24'
SECTION E	29,000	181	145	3,444	1,972	2,440	2,181	28	120'	241'	24'
SECTION F	44,360	277	222	5,410	2,988	3,580	3,318	43	184'	241'	24'
<b>PRE-FUNCTION SPACE</b>	<b>31,800</b>										
<b>9 OFFICES (LOCKABLE)</b>											
<b>5 REGISTRATION DESKS (LOCKABLE)</b>											
<b>BELLDISK</b>											
<b>LUGGAGE STORAGE</b>											
<b>VALET PARKING</b>											

Capacities shown are maximum for each room, with no staging or audio-visual, and should be used for reference only. Room capacities will be diminished based on your staging and audio-visual needs.



# GAYLORD PALMS EMERALD BAY

## ATRIUM LEVEL

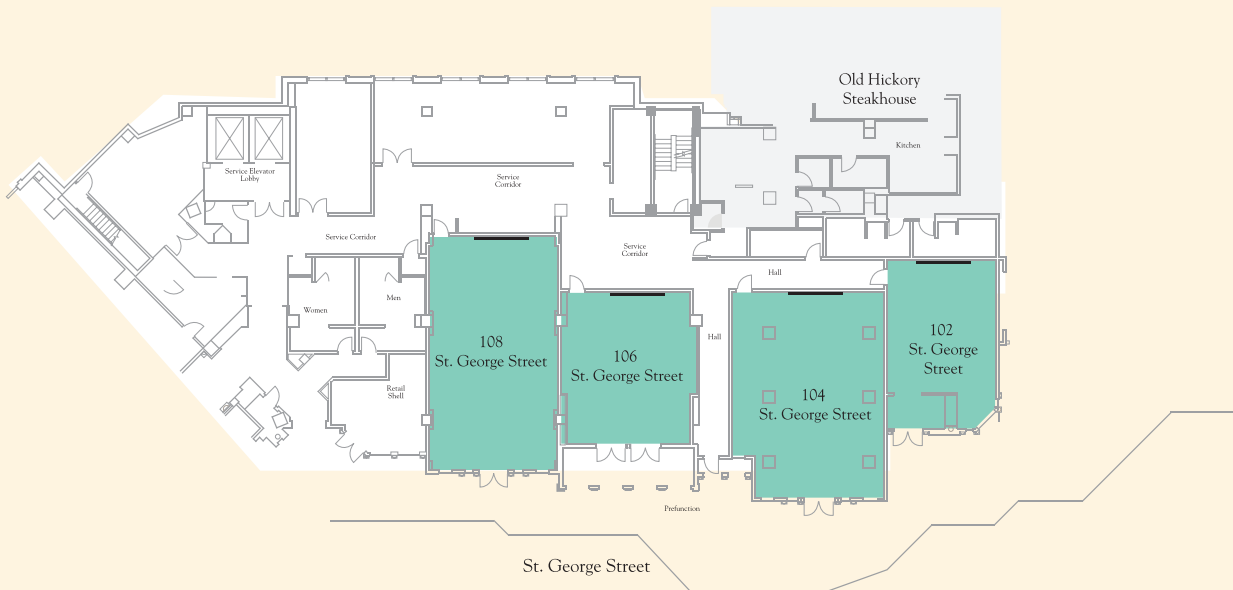
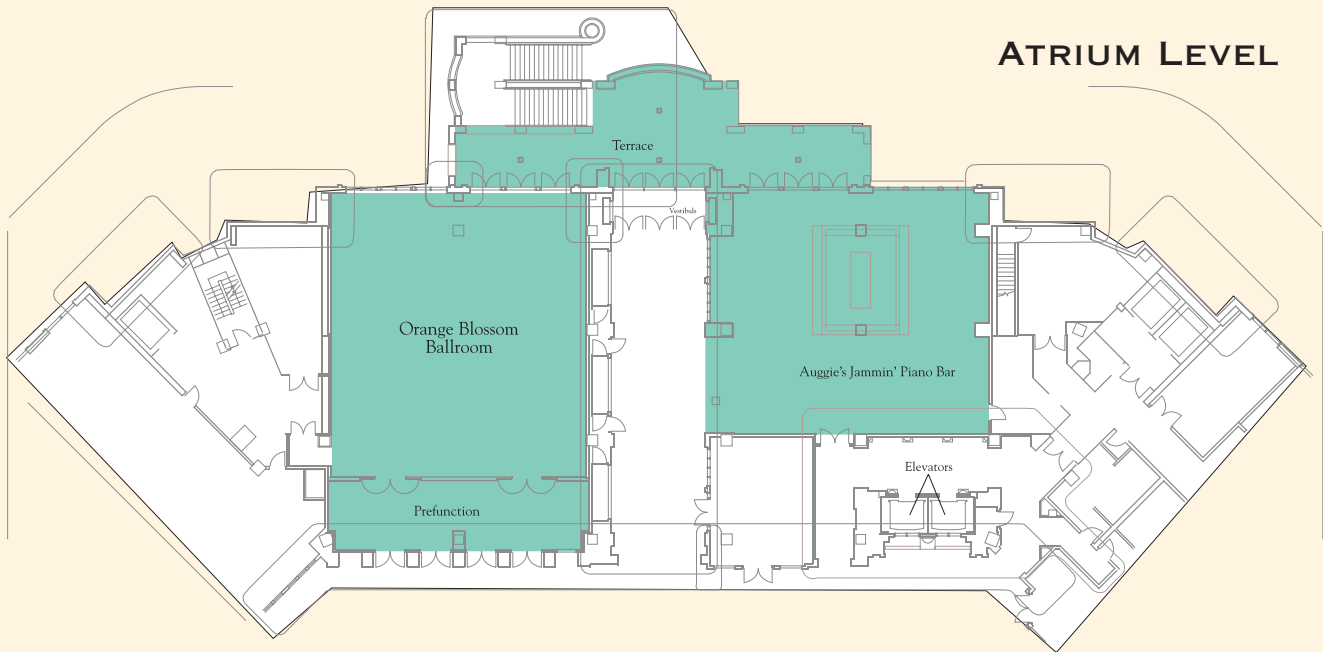

MEETING ROOMS	TOTAL SQ. FT.	THEATER	BANQUET	CLASSROOM	CONF/HOLLOW SQ.	U CONFERENCE	RECEPTION	WIDTH	LENGTH	CEILING HT
<b>ATRIUM LEVEL</b>										
ORANGE BLOSSOM BALLROOM	3,115	312	240	189	82	59	270	53'	59'	12'
ST. GEORGE 102	752	72	40	39	28	20	65	22'	35'	10'
ST. GEORGE 104	1,231	100	60	49	42	34	105	31'	43'	10'
ST. GEORGE 106	834	94	60	55	34	36	70	27'	32'	10'
ST. GEORGE 108	1,269	168	80	90	52	42	110	27'	49'	10'

Capacities shown are maximum for each room, with no staging or audio-visual, and should be used for reference only. Room capacities will be diminished based on your staging and audio-visual needs.



# GAYLORD PALMS EMERALD BAY CONT.

## POOL LEVEL



## FOURTH FLOOR

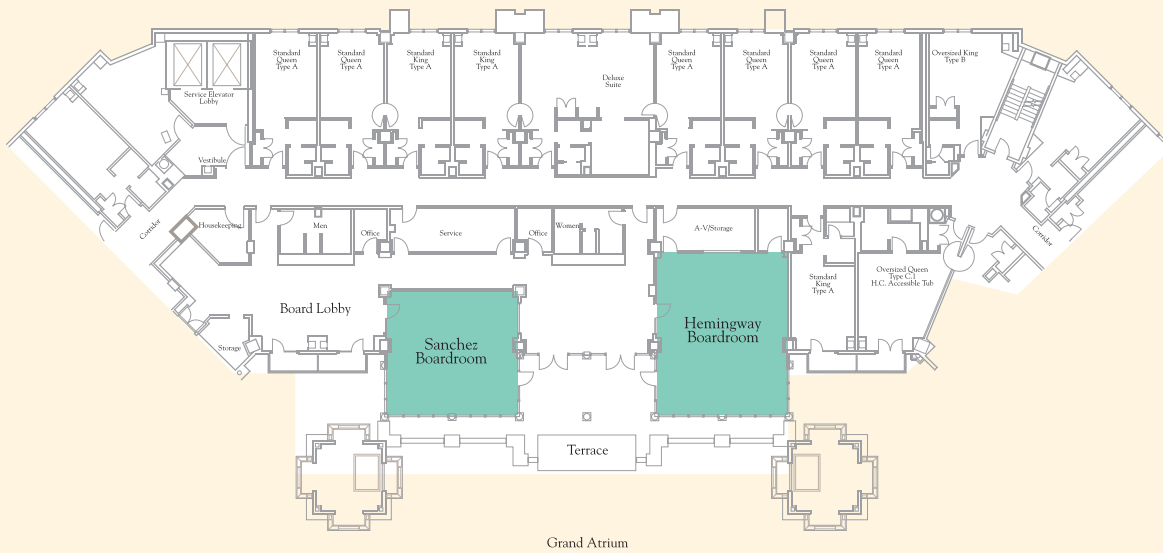

MEETING ROOMS	TOTAL SQ. FT.	THEATER	BANQUET	CLASSROOM	CONF/HOLLOW SQ.	U CONFERENCE	RECEPTION	WIDTH	LENGTH	CEILING HT
<b>POOL LEVEL</b>										
EMERALD 1	636	65	40	39	30	22	55	31'	22'	9'
EMERALD 2	1,021	114	60	64	44	36	90	26'	41'	9'
EMERALD 3	574	49	40	32	30	22	50	27'	22'	9'
EMERALD 4	1,059	110	60	64	44	36	90	27'	41'	9'
EMERALD 5	573	49	40	32	30	22	50	27'	22'	9'
EMERALD 6	1,061	110	60	64	44	36	90	27'	41'	9'
EMERALD 7	566	49	40	32	30	22	50	27'	22'	9'
EMERALD 8	1,034	115	60	63	44	36	90	26'	41'	9'
<b>FOURTH FLOOR</b>										
SANCHEZ BOARDROOM	700	Featuring Permanent Boardroom Tables		12 PPL				26'	27'	12'
HEMINGWAY BOARDROOM	919			14 PPL				28'	33'	12'

Capacities shown are maximum for each room, with no staging or audio-visual, and should be used for reference only. Room capacities will be diminished based on your staging and audio-visual needs.