

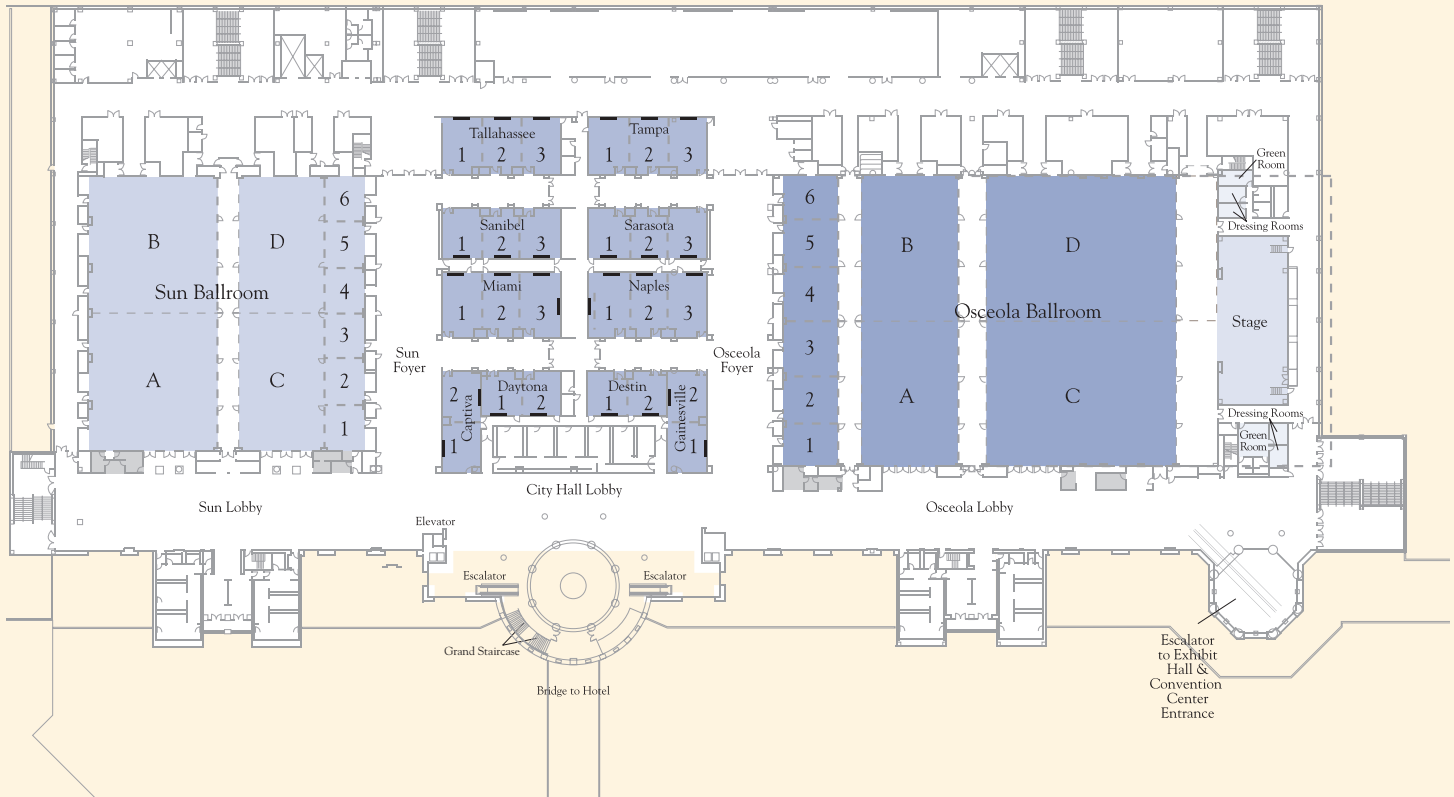

# GAYLORD PALMS BALLROOM LEVEL



MEETING ROOM	TOTAL SQ. FT.	THEATER	BANQUET	CLASSROOM	CONF/HOLLOW SQ.	U CONFERENCE	RECEPTION	WIDTH	LENGTH	CEILING HT.
<b>BALLROOM LEVEL</b>										
<b>SUN</b>	<b>29,014</b>	<b>3,040</b>	<b>1,960</b>	<b>1,860</b>			<b>2,520</b>	<b>179'</b>	<b>187'</b>	<b>24'</b>
A	6,682	665	490	450			580	84'	89'	24'
B	6,863	665	490	450			595	84'	98'	24'
C	4,350	418	280	285			375	52'	89'	24'
D	4,556	418	280	285			395	52'	98'	24'
AB/CD CORRIDOR	2,127							13'	187'	24'
<b>BREAKOUT 1</b>	<b>767</b>	<b>70</b>	<b>40</b>	<b>34</b>	<b>34</b>	<b>28</b>	<b>65</b>	<b>30'</b>	<b>33'</b>	<b>24'</b>
<b>BREAKOUT 2</b>	<b>762</b>	<b>72</b>	<b>40</b>	<b>45</b>	<b>34</b>	<b>26</b>	<b>65</b>	<b>30'</b>	<b>29'</b>	<b>24'</b>
<b>BREAKOUT 3</b>	<b>663</b>	<b>71</b>	<b>40</b>	<b>45</b>	<b>34</b>	<b>26</b>	<b>55</b>	<b>27'</b>	<b>27'</b>	<b>24'</b>
<b>BREAKOUT 4</b>	<b>667</b>	<b>71</b>	<b>40</b>	<b>45</b>	<b>34</b>	<b>26</b>	<b>60</b>	<b>27'</b>	<b>27'</b>	<b>24'</b>
<b>BREAKOUT 5</b>	<b>768</b>	<b>73</b>	<b>40</b>	<b>45</b>	<b>34</b>	<b>26</b>	<b>65</b>	<b>30'</b>	<b>29'</b>	<b>24'</b>
<b>BREAKOUT 6</b>	<b>809</b>	<b>69</b>	<b>40</b>	<b>34</b>	<b>34</b>	<b>28</b>	<b>70</b>	<b>30'</b>	<b>42'</b>	<b>24'</b>

Capacities shown are maximum for each room, with no staging or audio-visual, and should be used for reference only. Room capacities will be diminished based on your staging and audio-visual needs.



# GAYLORD PALMS BALLROOM LEVEL CONT.

MEETING ROOM	TOTAL SQ. FT.	THEATER	BANQUET	CLASSROOM	CONF/HOLLOW SQ.	U CONFERENCE	RECEPTION	WIDTH	LENGTH	CEILING HT.
<b>CITY HALL AREA</b>										
<b>CAPTIVA</b>	<b>1,364</b>	<b>138</b>	<b>90</b>	<b>88</b>	<b>54</b>	<b>48</b>	<b>120</b>	<b>23'</b>	<b>61'</b>	<b>12'</b>
1	676	72	40	40	30	21	60	23'	30'	12'
2	688	72	40	40	30	21	60	23'	31'	12'
<b>DAYTONA</b>	<b>1,193</b>	<b>118</b>	<b>70</b>	<b>85</b>	<b>48</b>	<b>40</b>	<b>105</b>	<b>48'</b>	<b>27'</b>	<b>12'</b>
1	592	59	40	30	28	20	50	24'	27'	12'
2	602	66	30	36	28	20	50	24'	27'	12'
<b>DESTIN</b>	<b>1,186</b>	<b>118</b>	<b>70</b>	<b>85</b>	<b>48</b>	<b>40</b>	<b>105</b>	<b>48'</b>	<b>27'</b>	<b>12'</b>
1	597	66	30	36	28	20	50	24'	27'	12'
2	589	62	40	30	28	20	50	24'	27'	12'
<b>GAINESVILLE</b>	<b>1,361</b>	<b>138</b>	<b>90</b>	<b>88</b>	<b>54</b>	<b>48</b>	<b>120</b>	<b>23'</b>	<b>61'</b>	<b>12'</b>
1	674	72	40	40	30	21	60	23'	30'	12'
2	687	72	40	40	30	21	60	23'	31'	12'
<b>MIAMI</b>	<b>2,626</b>	<b>272</b>	<b>210</b>	<b>193</b>	<b>84</b>	<b>73</b>	<b>230</b>	<b>72'</b>	<b>39'</b>	<b>12'</b>
1	881	104	60	60	38	29	75	24'	39'	12'
2	858	101	60	60	38	29	75	24'	39'	12'
3	887	105	60	66	38	29	75	24'	39'	12'
<b>NAPLES</b>	<b>2,602</b>	<b>272</b>	<b>210</b>	<b>193</b>	<b>84</b>	<b>73</b>	<b>225</b>	<b>71'</b>	<b>39'</b>	<b>12'</b>
1	882	105	60	66	38	29	75	23'	39'	12'
2	848	101	60	60	38	29	75	24'	39'	12'
3	872	104	60	60	38	29	75	24'	39'	12'
<b>SANIBEL</b>	<b>2,023</b>	<b>238</b>	<b>120</b>	<b>132</b>	<b>76</b>	<b>66</b>	<b>175</b>	<b>72'</b>	<b>30'</b>	<b>12'</b>
1	700	84	40	44	32	24	60	24'	30'	12'
2	642	65	40	40	30	22	55	24'	30'	12'
3	681	79	40	46	30	24	60	24'	30'	12'
<b>SARASOTA</b>	<b>2,018</b>	<b>238</b>	<b>120</b>	<b>132</b>	<b>76</b>	<b>66</b>	<b>175</b>	<b>71'</b>	<b>30'</b>	<b>12'</b>
1	674	79	40	46	30	22	60	23'	30'	12'
2	644	65	40	40	30	22	22	24'	30'	12'
3	700	84	40	44	32	24	60	24'	30'	12'
<b>TALLAHASSEE</b>	<b>2,273</b>	<b>249</b>	<b>150</b>	<b>170</b>	<b>78</b>	<b>69</b>	<b>200</b>	<b>72'</b>	<b>34'</b>	<b>12'</b>
1	777	84	50	50	34	24	70	25'	34'	12'
2	699	78	50	45	34	24	60	23'	34'	12'
3	797	98	50	56	34	24	70	24'	34'	12'
<b>TAMPA</b>	<b>2,269</b>	<b>249</b>	<b>150</b>	<b>170</b>	<b>78</b>	<b>69</b>	<b>200</b>	<b>70'</b>	<b>34'</b>	<b>12'</b>
1	794	84	50	48	34	24	70	24'	34'	12'
2	694	78	50	45	34	24	60	22'	34'	12'
3	781	84	50	50	34	24	70	24'	34'	12'
<b>BALLROOM LEVEL CONT.</b>										
<b>OSCEOLA</b>	<b>46,748</b>	<b>5,561</b>	<b>3,450</b>	<b>3,366</b>			<b>4,200</b>	<b>265'</b>	<b>190'</b>	<b>24'</b>
A	5,208	560	400	322			450	59'	94'	24'
B	5,326	560	400	322			460	59'	96'	24'
C	10,270	1,092	700	660			890	115'	94'	24'
D	10,385	1,092	700	660			900	115'	96'	24'
AB/CD CORRIDOR	2,792							14'	190'	24'
CD/STAGE CORRIDOR	4,328							23'	190'	24'
1-6/AB CORRIDOR	2,186							12'	190'	24'
<b>BREAKOUT 1</b>	<b>949</b>	<b>89</b>	<b>60</b>	<b>49</b>	<b>40</b>	<b>29</b>	<b>80</b>	<b>39'</b>	<b>32'</b>	<b>24'</b>
<b>BREAKOUT 2</b>	<b>1,005</b>	<b>105</b>	<b>70</b>	<b>63</b>	<b>40</b>	<b>29</b>	<b>90</b>	<b>39'</b>	<b>29'</b>	<b>24'</b>
<b>BREAKOUT 3</b>	<b>1,171</b>	<b>112</b>	<b>90</b>	<b>74</b>	<b>46</b>	<b>32</b>	<b>100</b>	<b>39'</b>	<b>33'</b>	<b>24'</b>
<b>BREAKOUT 4</b>	<b>1,132</b>	<b>112</b>	<b>90</b>	<b>74</b>	<b>46</b>	<b>32</b>	<b>100</b>	<b>39'</b>	<b>32'</b>	<b>24'</b>
<b>BREAKOUT 5</b>	<b>1,008</b>	<b>105</b>	<b>80</b>	<b>69</b>	<b>40</b>	<b>30</b>	<b>85</b>	<b>39'</b>	<b>29'</b>	<b>24'</b>
<b>BREAKOUT 6</b>	<b>988</b>	<b>93</b>	<b>60</b>	<b>50</b>	<b>40</b>	<b>30</b>	<b>85</b>	<b>39'</b>	<b>35'</b>	<b>24'</b>
<b>STAGE</b>										
<b>STAGE 42' X 96'</b>										
STAGE LEFT		GREEN ROOM 1—200 SQ. FT.		DRESSING ROOM 1—150 SQ. FT.			DRESSING ROOM 3—180 SQ. FT.			
STAGE RIGHT		GREEN ROOM 2—250 SQ. FT.		DRESSING ROOM 2—150 SQ. FT.						
<b>7 OFFICES (LOCKABLE)</b>		<b>RANGE 65–163 SQ. FT.</b>								
<b>6 REGISTRATION DESKS (LOCKABLE)</b>		<b>APPROX. 80 SQ. FT.</b>								

Capacities shown are maximum for each room, with no staging or audio-visual, and should be used for reference only. Room capacities will be diminished based on your staging and audio-visual needs.